

# Kitchen Countertop Power Outlet

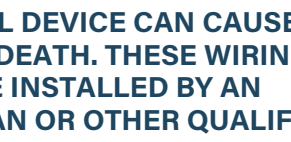

CP498TR15,  
CP498TR20, CP498L

Made in China

## General Information:

- To prevent severe shock or electrocution, always turn power OFF at the service panel before working with wiring.
- Must be installed in accordance with National and Local electrical codes.

**WARNING: IMPROPER WIRING OF ANY ELECTRICAL DEVICE CAN CAUSE SERIOUS INJURY OR DEATH. THESE WIRING DEVICES SHOULD BE INSTALLED BY AN ELECTRICIAN OR OTHER QUALIFIED PERSON.**

**WARNING:** MUST be connected to a GFCI receptacle or Circuit.

**NOTICE:** This device is not intended for feed through wiring.

**NOTICE:** For indoor use only.

Suitable for use in a Kitchen/Bathroom Countertop with thickness 0.50" -1.6"

This Product is a Listed Receptacle Assembly for Kitchen and Bathroom Countertops per NEC 406.5(E) and UL 498 Section 146.

UL 498 Section 146-151

Receptacle and Tail Assembly is suitable for install without a junction box.

Built and listed to be water resistant to a half gallon of liquid spilled on the device.

NEC 406.5(E)

Receptacle assemblies for installation in countertop surfaces shall be listed for countertop applications.

This Product is Suitable for Work Surfaces per NEC 406.5(F)

This Product is suitable for use with non-metallic cable (NM), metal-clad cable (MC), and metal conduit (EMT).

This Product accepts #10-#14AWG solid and stranded copper wire and copper-clad wire.

Pressure wire termination only.

## Product Description:

The Kitchen Countertop Outlet is a code-compliant, UL 498-certified solution for kitchen islands and peninsulas, featuring a compact design and quick connection for easy installation. Passing a strict half-gallon spill test, the outlet ensures reliability and performance, offering the utmost safety for homeowners. The outlet can withstand strong wear and tear, with built-in corrosion/chemical resistance, and the surface-mount design makes everyday cleaning easy to help maintain long-term aesthetic. Purchase the outlet with an optional lid, which comes in four cast metal options to match or complement kitchen finishes.

## Installation:

### Installation with Lid:

1. Gather required materials:
  - a. CP498TR Device and Tail
  - b. Lid (CP498L \* Sold Separately)
  - c. GFCI protected circuit
  - d. Suitable cable for your installation
  - e. Suitable ½" cable connector for your installation
  - f. 2-1/4" Hole saw or similar tool
2. Locate countertop area for install. Ensure the bottom of the counter surface is free of debris and irregularities.
3. Using a hole saw or similar tool, drill a hole in the countertop.

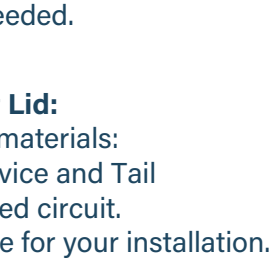

4. Remove sharp edges from the hole opening.

5. Strip cable/conduit sheathing leaving 3.5 inches of insulated conductors exposed.

6. Remove the 2 screws from the back cover of the tail and remove the cover. Install ½" cable connector in to the tail hole and secure cable/ conduit.

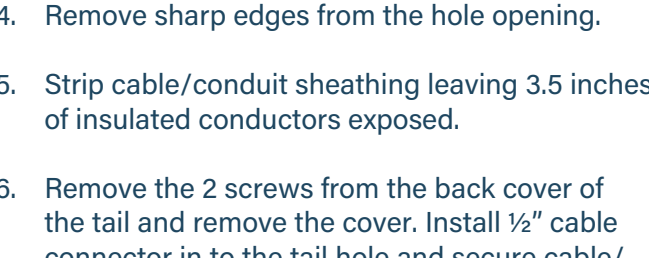

7. Strip conductors according to the strip gage provided on the device and connect to the proper terminals, pressure wire termination only:

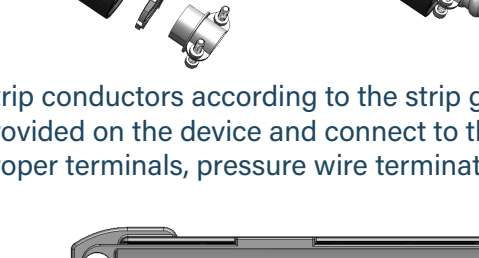

- a. Note: The tail can be wired above the counter and fit back through the hole.

Terminal	Conductor
GREEN	Grounding conductor (Green wire)
WHITE	Neutral, (White or Gray wire)
HOT	Circuit Conductor (Typically Black or Red)

Torque terminal screws to 14-16 inch-pounds.

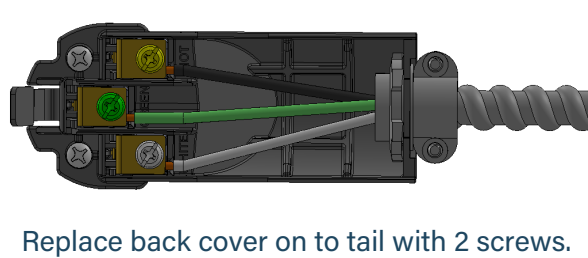

8. Replace back cover on to tail with 2 screws. Torque tail screws to 4-6 inch-pounds.

9. Insert lid onto the top surface of the hole. Align the lid in its desired direction.

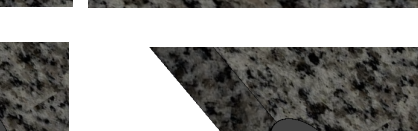

10. Insert device body into the lid and hole and hand tighten the nut underneath the counter. **Use tongue and groove pliers or a similar tool to turn the nut a final 1/2 turn to secure the device. Do not overtighten.**

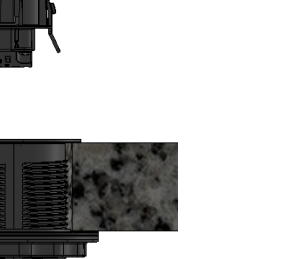
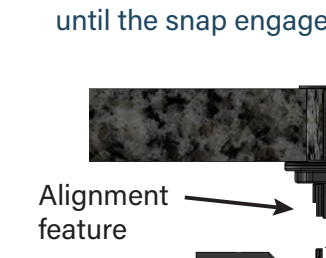

11. Align post with alignment feature and insert the tail into the body of the device until the snap engages.

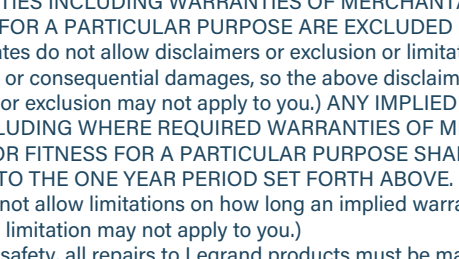
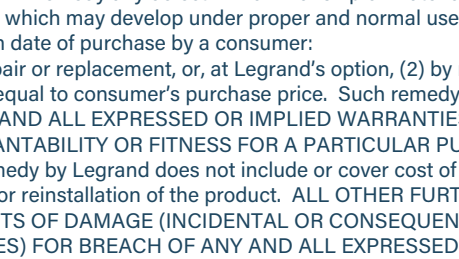

12. Terminate cable to the GFCI protected circuit and secure as needed.

### Installation without Lid:

1. Gather required materials:
  - a. CP498TR Device and Tail
  - b. GFCI protected circuit.
  - c. Suitable cable for your installation.
  - d. Suitable ½" cable connector for your installation.
  - e. 2" Hole saw or similar tool.
2. Locate countertop area for install. Ensure the bottom of the counter surface is free of debris and irregularities.
3. Using a hole saw or similar tool, drill a hole in the countertop.



4. Remove sharp edges from the hole opening.

5. Strip cable/conduit sheathing leaving 3.5 inches of insulated conductors exposed.

6. Remove the 2 screws from the back cover of the tail and remove the cover. Install ½" cable connector in to the tail hole and secure cable/ conduit. Install ½" cable connector into the tail hole and secure cable/ conduit.



7. Strip conductors according to the strip gage provided on the device and connect to the proper terminals, pressure wire termination only:



- a. Note: The tail can be wired above the counter and fit back through the hole.

Terminal	Conductor
GREEN	Grounding conductor (Green wire)
WHITE	Neutral, (White or Gray wire)
HOT	Circuit Conductor (Typically Black or Red)

Torque terminal screws to 14-16 inch-pounds.



8. Replace back cover on to tail with 2 screws. Torque tail screws to 4-6 inch-pounds.

9. Insert device body into the hole and hand tighten the nut underneath the counter. **Use tongue and groove pliers or a similar tool to turn the nut a final 1/2 turn to secure the device. Do not overtighten.**



10. Insert the tail into the body of the device until the snap engages.



11. Terminate cable to the GFCI protected circuit and secure as needed.

### LIMITED ONE YEAR WARRANTY

Legrand will remedy any defect in workmanship or material in Legrand products which may develop under proper and normal use within one year from date of purchase by a consumer:

(1) by repair or replacement, or, at Legrand's option, (2) by return of an amount equal to consumer's purchase price. Such remedy is IN LIEU OF ANY AND ALL EXPRESSED OR IMPLIED WARRANTIES OF MERCHANTABILITY OR FITNESS FOR A PARTICULAR PURPOSE. Such remedy by Legrand does not include or cover cost of labor for removal or reinstallation of the product. ALL OTHER FURTHER ELEMENTS OF DAMAGE (INCIDENTAL OR CONSEQUENTIAL DAMAGES) FOR BREACH OF ANY AND ALL EXPRESSED OR IMPLIED WARRANTIES INCLUDING WARRANTIES OF MERCHANTABILITY OR FITNESS FOR A PARTICULAR PURPOSE ARE EXCLUDED HEREBY. (Some states do not allow disclaimers or exclusion or limitation of incidental or consequential damages, so the above disclaimer and limitation or exclusion may not apply to you.) ANY IMPLIED WARRANTIES INCLUDING WHERE REQUIRED WARRANTIES OF MERCHANTABILITY OR FITNESS FOR A PARTICULAR PURPOSE SHALL BE LIMITED TO THE ONE YEAR PERIOD SET FORTH ABOVE. (Some states do not allow limitations on how long an implied warranty lasts, so the above limitation may not apply to you.)

To insure safety, all repairs to Legrand products must be made by Legrand, or under its specific direction. Procedure to obtain performance of any warranty obligation is as follows: (1) Contact Legrand, Syracuse, New York 13221, for instructions concerning return or repair; (2) return the product to Legrand, postage paid, with your name and address and a written description of the installation or use of the Legrand product, and the observed defects or failure to operate, or other claimed basis for dissatisfaction. This warranty gives you specific legal rights and you may also have other rights which vary from state to state.